



EASTWOOD ANDREWS



2/6 Loris Close Grovedale VIC

3 2 1

This low maintenance townhouse makes the perfect choice for both owner occupiers and investors, with a potential rental income of \$370 per week.

Situated on its own allotment, with no shared land, the property offers seclusion and privacy in an extremely convenient location, minutes to the train station, shops, schools and only 10 minutes to town. Providing plenty of space inside with an open plan kitchen/dining/family area with stunning Brushbox timber flooring and plenty of natural light. A reverse cycle airconditioner provides all year round comfort. The kitchen has plenty of cupboard space, stainless steel 900mm freestanding oven and a dishwasher. There are three bedrooms, two with built in robes, master with walk in robe and ensuite. The central bathroom has a separate bath and shower and separate toilet. Recently painted, there is truly nothing to do but move in and enjoy the lifestyle this property and location

Price : \$ 407,000

View : <https://www.eastwoodandrews.com.au/sale/vic/geelong-district/grovedale/residential/townhouse/5927701>



Nicole Andrews
03 5201 0575

<https://www.eastwoodandrews.com.au>

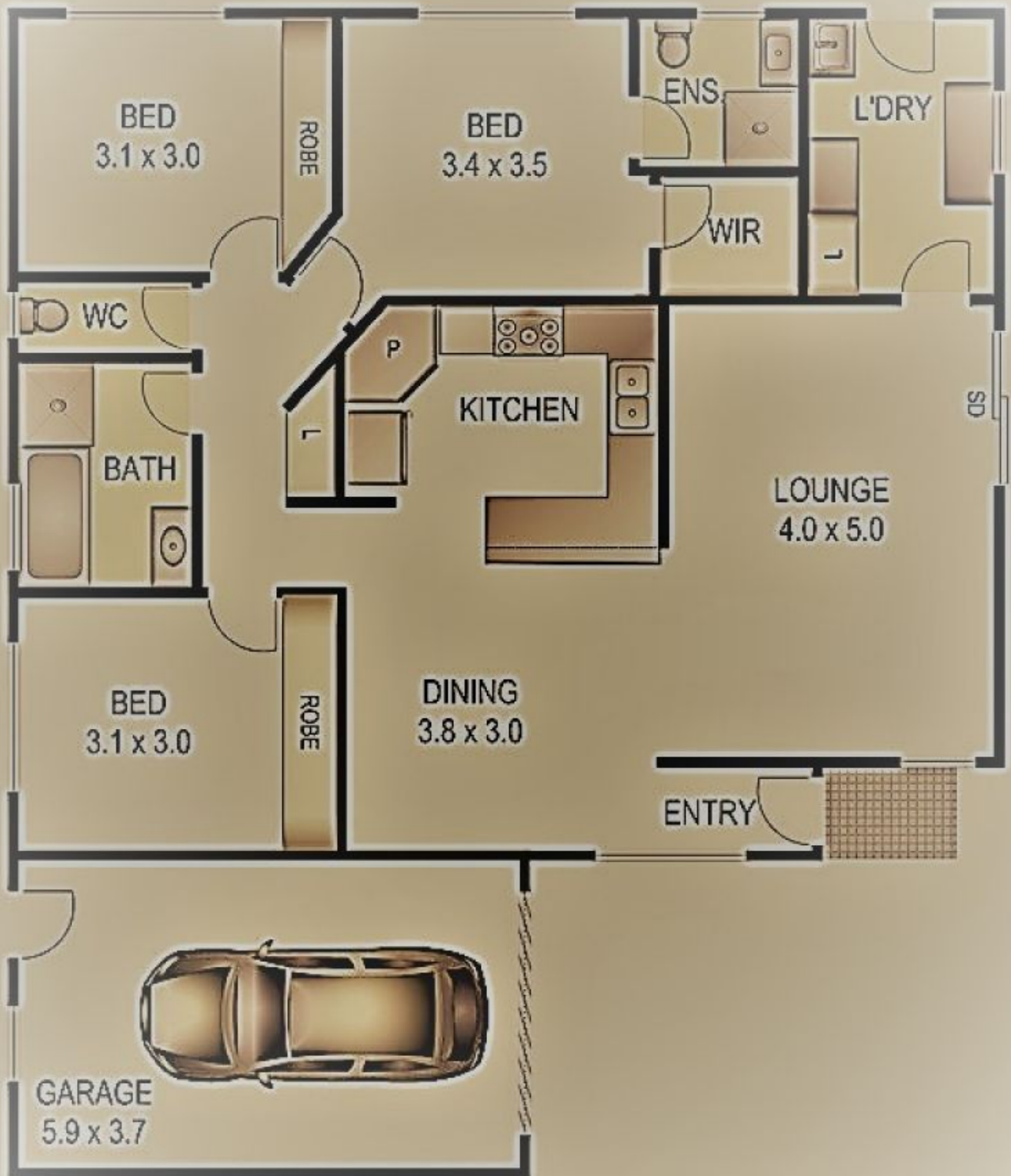

*This plan is for promotional & illustrative purposes only. Every effort is made to ensure precision in measurements, however accuracy is not guaranteed.