



EASTWOOD ANDREWS



28 Greenfields Drive Moriac VIC

5 2 6

We are hearing a lot about the "new normal", well there is no better home, location or lifestyle to live than here in the country community of Moriac.

Before you is an abundant family home situated on 1788m² approx with a vast rural outlook.

The grand entrance hall is just the beginning of what is to come:

5 bedrooms all with ceiling fans, master obviously with walk in robe and huge en suite and all the other 4 bedrooms have built in robes.

Large central family bathroom and ducted vacuuming throughout.

Rumpus room and open plan kitchen/dining/living area which has a wood fire. Plus there is a formal dining/lounge room; all three living areas have split system heating/cooling for all year round comfort.

Internally the home has recently been repainted and fitted

Price : \$ 910,000

Land Size : 1788 sqm

View : <https://www.eastwoodandrews.com.au/sale/vic/geelong-district/moriac/residential/house/5927769>

<https://www.eastwoodandrews.com.au>

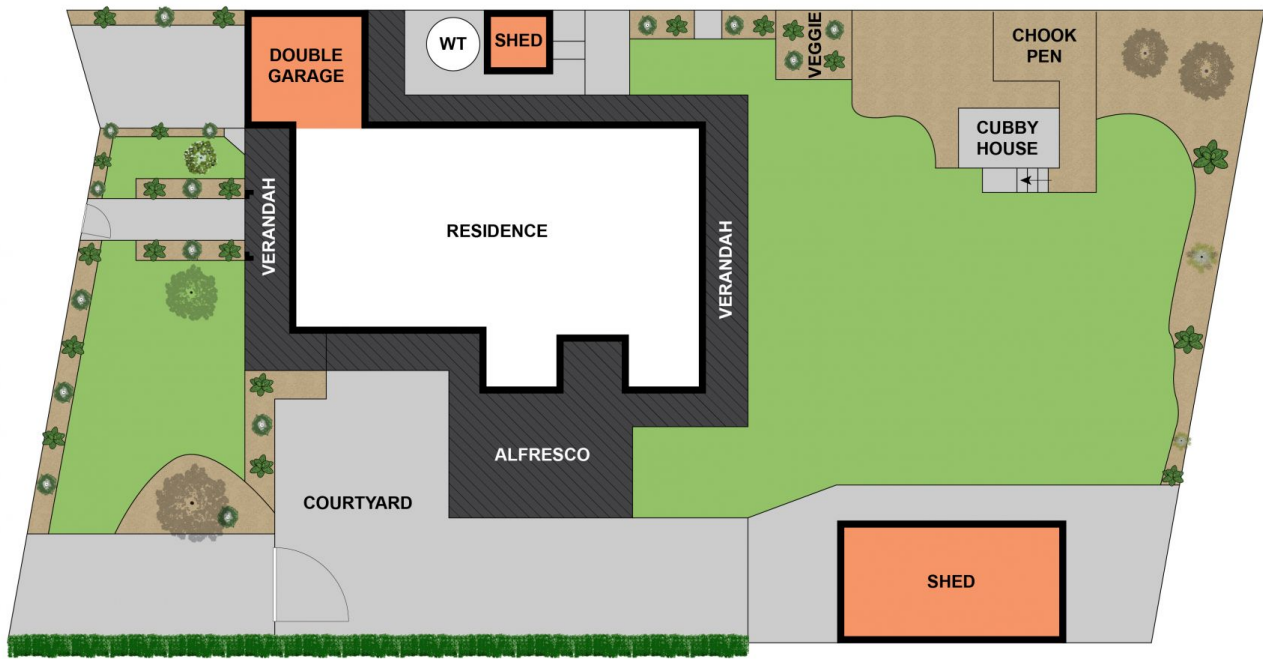

SITE PLAN

Whilst bwrn.com.au has made every attempt to ensure the accuracy of the floor plan contained here, measurements are approximate and no responsibility is taken for any error, omission, or mis-statement. This plan is for illustrative purposes only.

28 Greenfields Drive, Moriac

EA
EASTWOOD ANDREWS



Whilst bwrn.com.au has made every attempt to ensure the accuracy of the floor plan contained here, measurements are approximate and no responsibility is taken for any error, omission, or mis-statement. This plan is for illustrative purposes only.

28 Greenfields Drive, Moriac

EA
EASTWOOD ANDREWS