



EASTWOOD ANDREWS



2/92 Helms Street Newcomb VIC

3 2 2

This 5 year old townhouse is sure to impress. Situated minutes from the local shopping centres, sporting reserves and public transport and only 10 minutes to Geelong CBD and coastal areas, this makes the perfect location. Ideal for owner occupiers and investors, with a potential rental income of \$410/week.

Price : \$ 590,000
Land Size : 447 sqm
View : <https://www.eastwoodandrews.com.au/sale/vic/geelong-district/newcomb/residential/townhouse/7357778>

Features:

- Open plan kitchen/dining/family
- Well appointed kitchen with stainless steel gas cooktop, electric oven and dishwasher
- 3 spacious bedrooms, master with ensuite and walk in robe.
- Main bathroom provides a separate bath and shower and separate toilet.
- A reverse cycle airconditioner allows comfort all year round.



Nicole Andrews
03 5201 0575



Jayden Overall
03 5201 0575

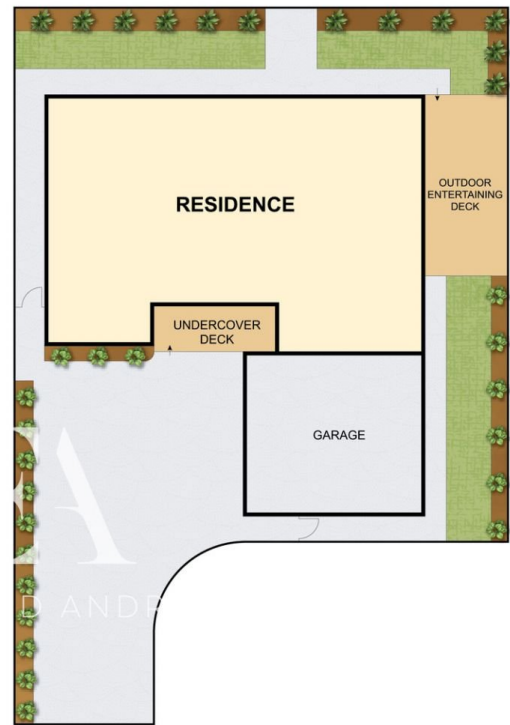

THE ABOVE PLAN IS AN ARTIST'S IMPRESSION ONLY. IT INCLUDES ELEMENTS THAT ARE FOR DISPLAY PURPOSES ONLY AND MAY NOT BE TO SCALE. LANDSCAPING SHOWN IS INDICATIVE ONLY. DIMENSIONS ARE APPROXIMATE.