



EASTWOOD ANDREWS



2/12 Cheltenham Road Newcomb VIC

2 1 1

Beautifully presented townhouse tucked neatly into a beautiful pocket!

The open plan living/dining/kitchen zone will take your breath away upon entry. A gas log fireplace to keep cosy throughout winter articulates the living space and enhances the entertaining area, perfect for welcoming in loved ones to your home. In the summertime, a large glass sliding door broadens your entertainment opportunity into the outdoors which is fully outfitted with a sail shade. Lined with bamboo fencing and a well-maintained edible garden, this is simply the perfect place to enjoy fun-filled gatherings or relax reading a book.

Bordering close to East Geelong in a peaceful street, this home is just a short walk to local shops and public transport. Just a stones throw from the Portarlington

Price : \$ 570,000
View : <https://www.eastwoodandrews.com.au/sale/vic/geelong-district/newcomb/residential/unit/7543227>



Amanda Frick
03 52010575

<https://www.eastwoodandrews.com.au>

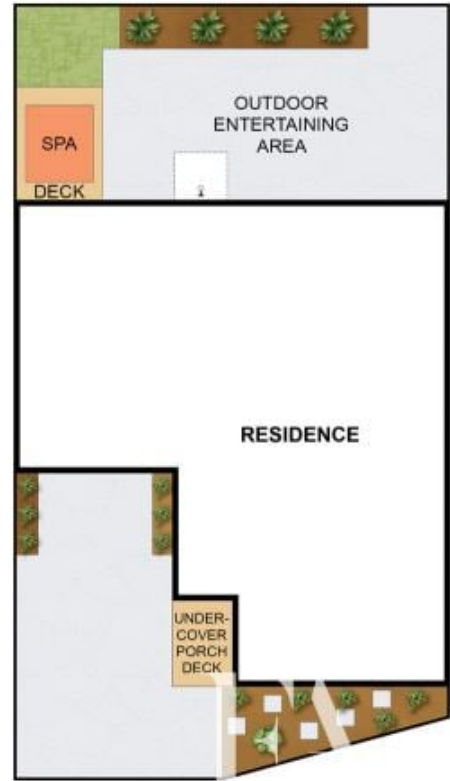

THE ABOVE PLAN IS AN ARTIST'S IMPRESSION ONLY. IT INCLUDES ELEMENTS THAT ARE FOR DISPLAY PURPOSES ONLY AND MAY NOT BE TO SCALE. LANDSCAPING SHOWN IS INDICATIVE ONLY. DIMENSIONS ARE APPROXIMATE.