



EASTWOOD ANDREWS



28 Westmoreland Street St Albans Park VIC

3 1 4

This comfortable and updated home offers an excellent opportunity to break into the Geelong property market at an appealing price bracket without any trade off for condition or location. Situated in the increasingly popular suburb of St Albans Park, only ten minutes to Geelong CBD, 15 minutes to coastal areas and a short drive to local shops, schools and sporting reserves, the convenience is why this suburb makes a wise investment. Perfect for first home buyers this quality home also presents a worthy addition to the investment portfolio, with an estimated rental income of \$420 per week.

Features:

- A spacious lounge adjoins the kitchen/dining area, with windows facing north and west to allow natural light to flood the main living space

Land Size : 590 sqm

View : <https://www.eastwoodandrews.com.au/sale/vic/geelong-district/st-albans-park/residential/house/7554263>



Nicole Andrews
03 5201 0575



Sarabjeet Singh
5201 0575

<https://www.eastwoodandrews.com.au>

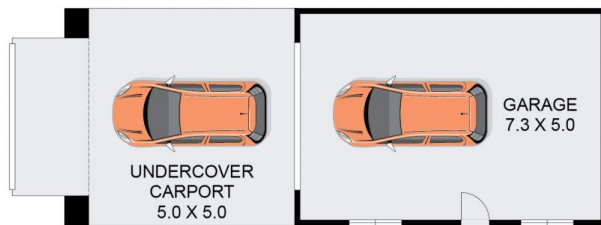

(NOT IN POSITION)

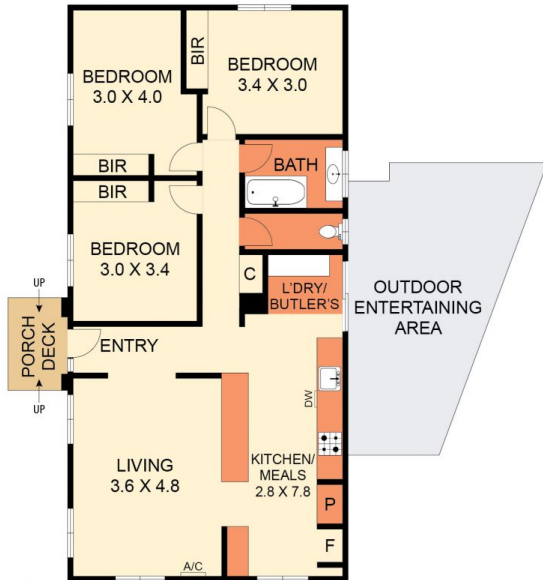

THE ABOVE PLAN IS AN ARTIST'S IMPRESSION ONLY. IT INCLUDES ELEMENTS THAT ARE FOR DISPLAY PURPOSES ONLY AND MAY NOT BE TO SCALE. LANDSCAPING SHOWN IS INDICATIVE ONLY. DIMENSIONS ARE APPROXIMATE.