



EASTWOOD ANDREWS



34 Neptune Avenue Newcomb VIC

3 1 3

Calling all First Home Buyers, Investors and Downsizers!

Set on a generous allotment in a highly sought-after pocket of Newcomb, only 6 minutes from Geelong CBD and waterfront with an amazing studio/4th bedroom option, this charming brick home with beautiful polished hardwood floors throughout ticks all the boxes.

Comprising of a charming light-filled lounge with a coonara wood fire, split system heating/cooling, ceiling fans for year round comfort and good sized bedrooms (3 with built in robes and block out blinds, the main with additional split system heating and cooling) this home is built for comfort and ready to move into right away to make your very own,

The key feature that sets his home apart from others is the brick studio/4th bedroom option in the rear yard, which has

Price : \$ 550,000
Land Size : 560 sqm
View : <https://www.eastwoodandrews.com.au/sale/vic/geelong-district/newcomb/residential/house/7619393>



Jayden Overall
03 5201 0575



Nicole Andrews
03 5201 0575

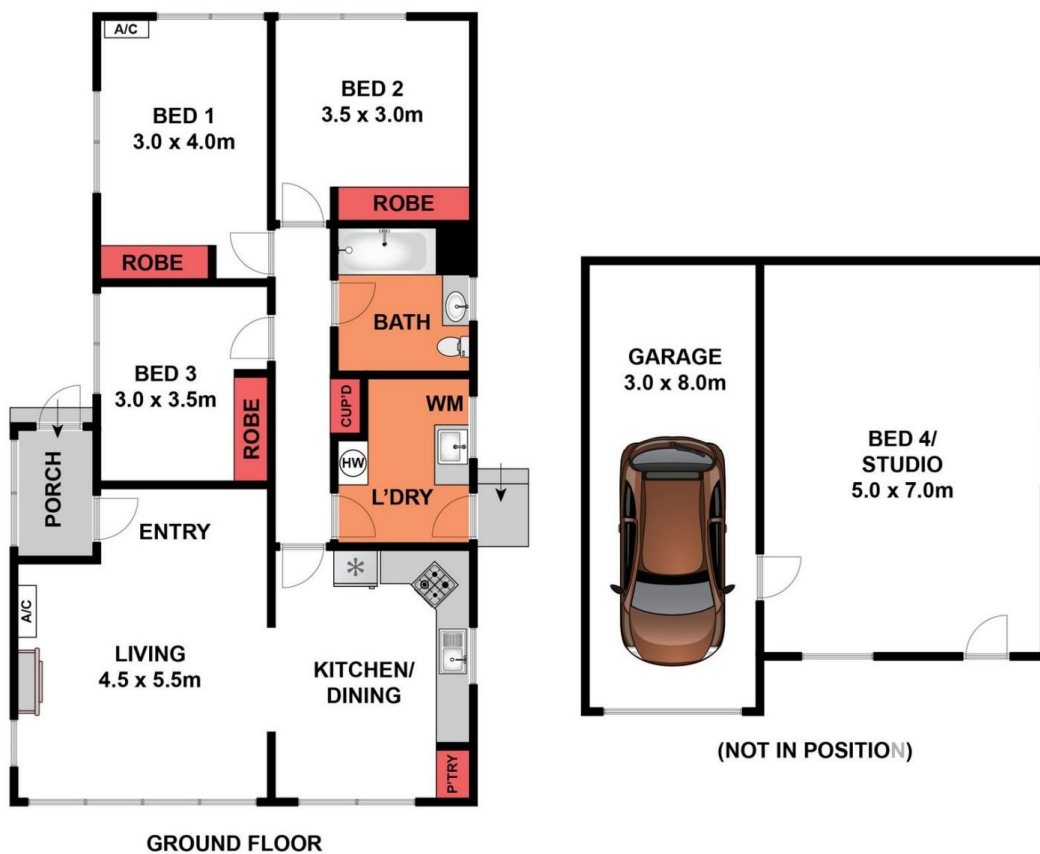

Whilst bwrn.com.au has made every attempt to ensure the accuracy of the floor plan contained here, measurements are approximate and no responsibility is taken for any error, omission, or mis-statement. This plan is for illustrative purposes only.

34 Neptune Avenue, Newcomb

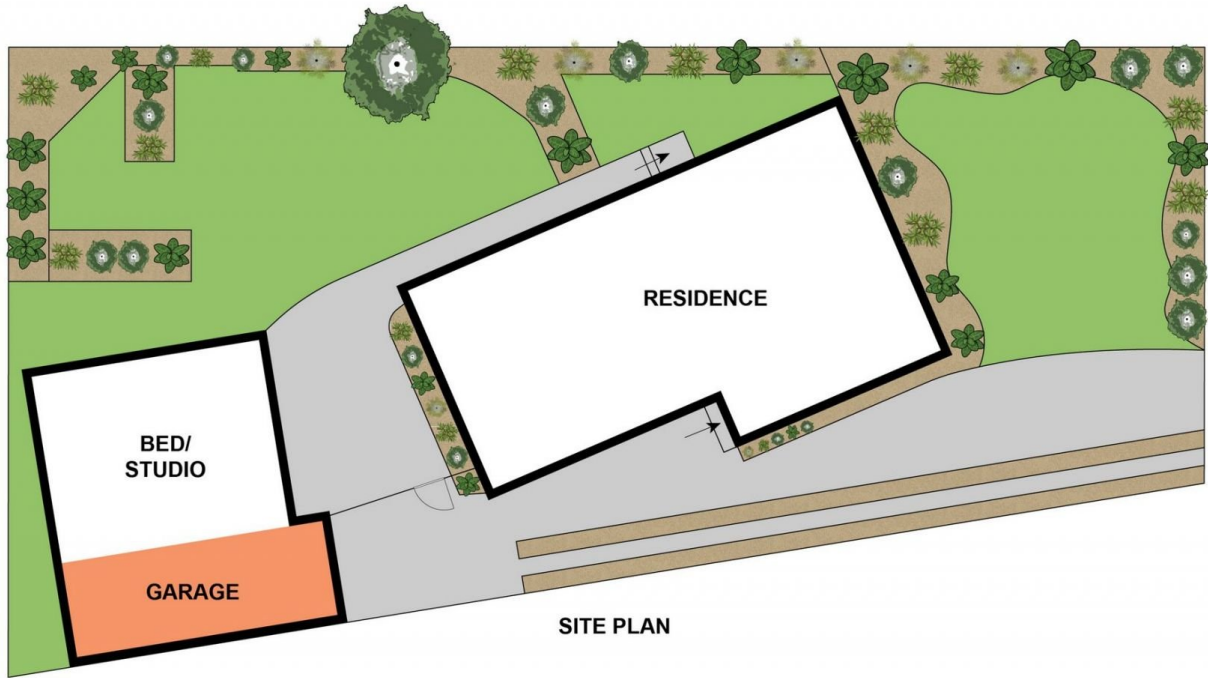

Whilst bwrn.com.au has made every attempt to ensure the accuracy of the floor plan contained here, measurements are approximate and no responsibility is taken for any error, omission, or mis-statement. This plan is for illustrative purposes only.

34 Neptune Avenue, Newcomb

EA
EASTWOOD ANDREWS