



50 Fitzroy Street Geelong VIC

4 1 4

Discover the timeless elegance on offer with this meticulously renovated Edwardian home. Set on the fringe on the CBD, this character home will delight those with a passion for old world charm, in one of the best streets Geelong has to offer. Displaying an ornate street frontage with cottage style garden the first impression is an indication of the charm and character of this home. Boasting a seamless fusion of period features and contemporary design, with high ceilings, ornate cornices, timber fretwork, picture rails, stunning light fittings and polished timber floors creating a warm and cosy atmosphere.

Features:

- Open plan lounge/dining/kitchen bathed in natural light and opening to the

Land Size : 348 sqm

View : <https://www.eastwoodandrews.com.au/sale/vic/geelong-district/geelong/residential/house/7817386>



Nicole Andrews
03 5201 0575



Andrew Crowhurst
03 5201 0575

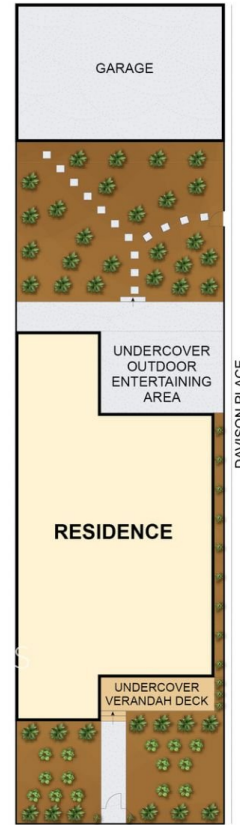
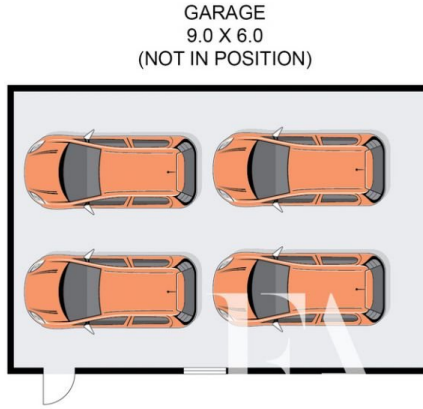

THE ABOVE PLAN IS AN ARTIST'S IMPRESSION ONLY. IT INCLUDES ELEMENTS THAT ARE FOR DISPLAY PURPOSES ONLY AND MAY NOT BE TO SCALE.
 LANDSCAPING SHOWN IS INDICATIVE ONLY. DIMENSIONS ARE APPROXIMATE.