



EASTWOOD ANDREWS



21 Gairloch Grove Newtown VIC

4 2 2

Situated in the leafy, prestigious locale of river side Newtown, this property offers spacious family living, across the road from the Barwon River and its walking tracks, walking distance to some of Geelong's best schools including Sacred Heart, Geelong College, St Joseph's College and Fyans Park Primary.

Land Size : 642 sqm
View : <https://www.eastwoodandrews.com.au/lease/vic/geelong-district/newtown/residential/home-use/7921964>

Features:

- Formal lounge and dining rooms with an open fire place.
- Well equipped kitchen/dining which opens out to the undercover area.
- 4 spacious bedrooms
- 2 renovated bathrooms
- On the upper level is a huge rumpus area which opens to a large decked area perfect for enjoying the views.
- Outdoors is surrounded by established and well



Beth McKay
03 5201 0575

<https://www.eastwoodandrews.com.au>



GROUND FLOOR

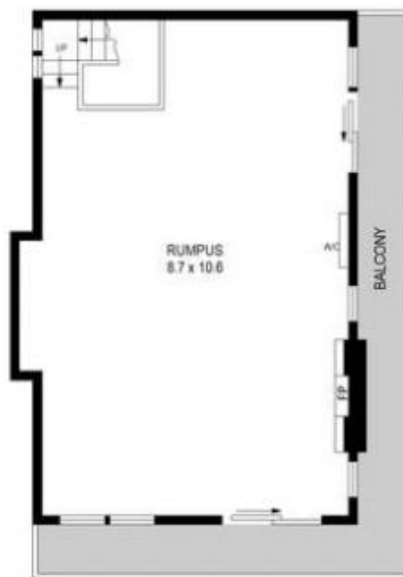

FIRST FLOOR

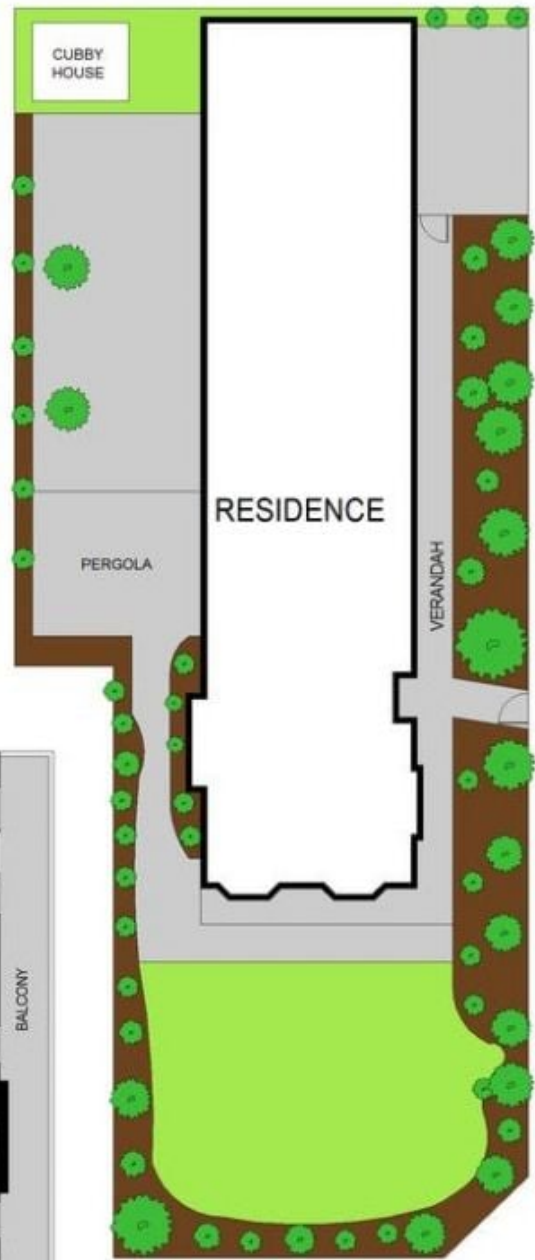

SITE PLAN



Scale in metres. Indicative only. Dimensions are approximate. All information contained herein is gathered from sources we believe to be reliable. However we cannot guarantee its accuracy and interested parties should rely on their own enquiries.

Ground Floor	- 154 m ²
First Floor	- 76 m ²
Garage	- 42 m ²
Verandah	- 36 m ²
Balcony	- 21 m ²
Cubby House	- 8 m ²
Pergola	- 27 m ²



21 Gairloch Grove, Newtown