



EASTWOOD ANDREWS



28 Neptune Avenue Newcomb VIC

4 2 2

Discover a unique opportunity to secure a smartly updated 4-bedroom, 2-bathroom home in Newcomb. Situated on a generous lot in a sought-after street, this property is just 6 minutes from Geelong CBD and waterfront. Featuring tasteful modern updates and polished hardwood floors throughout, this home is an ideal investment with great long-term renters currently paying \$450 per week, and a lease extending until May 2025.

Type : House
Price : \$ 575,000
Land Size : 535 sqm
View : <https://www.eastwoodandrews.com.au/sale/vic/geelong-district/newcomb/residential/house/8085906>

Key Features:

- Four bedrooms, each with built-in robes
- Modern kitchen open to a spacious dining area
- Split system heating and cooling
- Ceiling fans throughout

[For full version visit the website](https://www.eastwoodandrews.com.au)



Jayden Overall
03 5201 0575



Nicole Andrews
03 5201 0575

<https://www.eastwoodandrews.com.au>

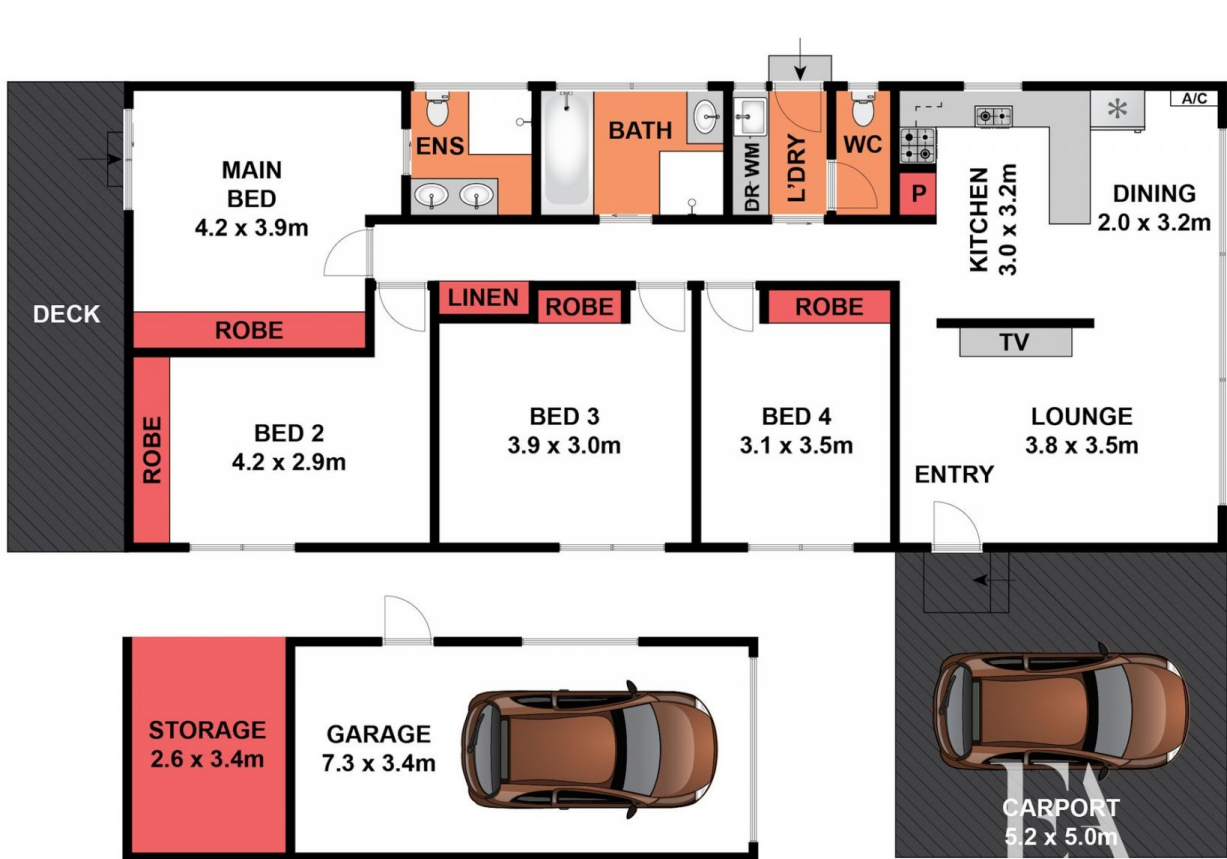

(NOT IN POSITION)

Whilst bwrn.com.au has made every attempt to ensure the accuracy of the floor plan contained here, measurements are approximate and no responsibility is taken for any error, omission, or mis-statement. This plan is for illustrative purposes only.

28 Neptune Avenue, Newcomb

EA
EASTWOOD ANDREWS

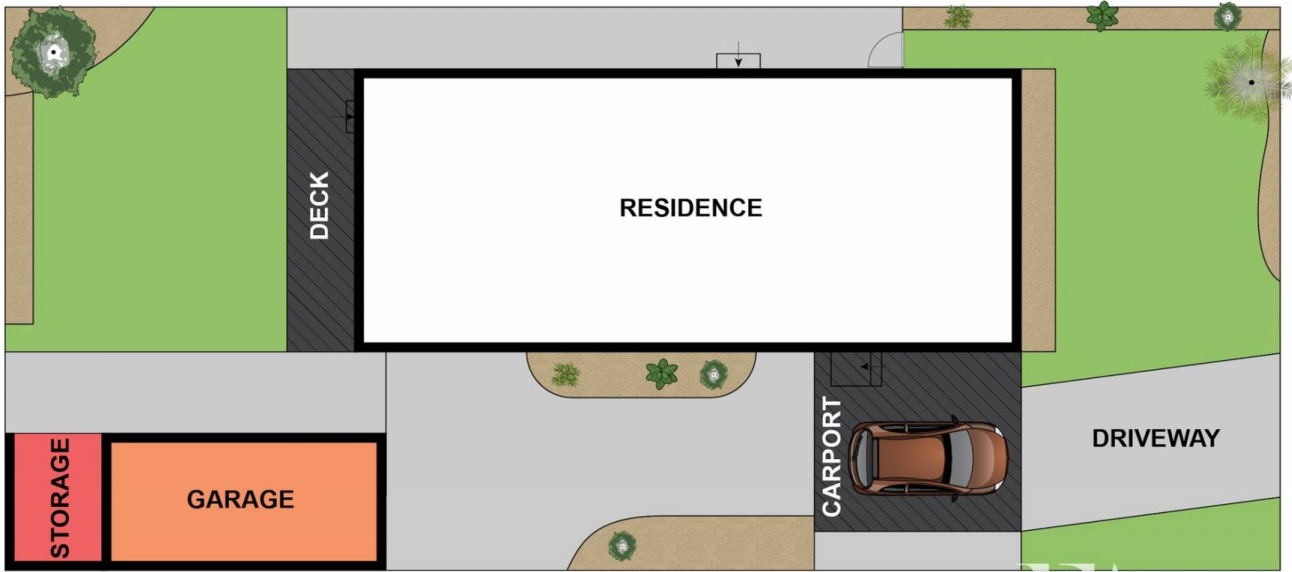

Whilst bwrn.com.au has made every attempt to ensure the accuracy of the floor plan contained here, measurements are approximate and no responsibility is taken for any error, omission, or mis-statement. This plan is for illustrative purposes only.

28 Neptune Avenue, Newcomb